

CROFTERS (SCOTLAND) ACT 1993

DECROFTING DIRECTION UNDER SECTIONS 24(3), 25(1)(a) AND 25(4)

PART CROFT DECROFTING

CROFT: Heogaland
COMMISSION REGISTER NUMBER: Z3128
PARISH: Tingwall
REGISTERS OF SCOTLAND
REGISTER NUMBER: C1879
AREA TO BE DECROFTED: 0.15 ha
AS SHOWN ON
ATTACHED PLAN: Hatched in red
CROFTER: Mr James Linklater Nicolson
DATE OF DIRECTION: 3 November 2015

We direct that the area as shown on the attached plan shall cease to be land to which the 1993 Act applies. We are satisfied that the purpose for which the land is to be used is a reasonable one and that the extent of the land is not excessive in relation to that purpose.

This Direction shall not have effect unless and until the land to which it relates has been acquired by the crofter or a nominee of the crofter within five years of the date of this Direction. The crofter must notify the Commission of the acquisition within 3 months. The Direction takes effect on the date notification of the acquisition is given by the Commission to the Keeper of the Registers of Scotland. This Direction is subject to the following conditions:

1. The land must as a first change of use, be used, let or disposed of as a site for a new dwelling house.
2. The land must be enclosed (so far as not already enclosed) with a stockproof fence within four months of the development being completed.
3. That fence shall be maintained in good order and repair by each successive owner or occupier of the land.

Authorised
Signatory

M DROSS
on behalf of the Crofting Commission



Note: In terms of section 25(3) of the Act of 1993 breach of the stated conditions, or any later modification of these, may entail the making of a further Direction by the Commission that the said land shall again be a vacant croft.



© Copyright Vega Technical Services (VTS)
No part of this document may be reproduced or transmitted in any form without the written permission of VTS.
This document should not be relied on or used in circumstances other than those for which it was originally
prepared and for which VTS was commissioned. VTS accepts no responsibility for this document to any other
party other than the person by whom it was commissioned.

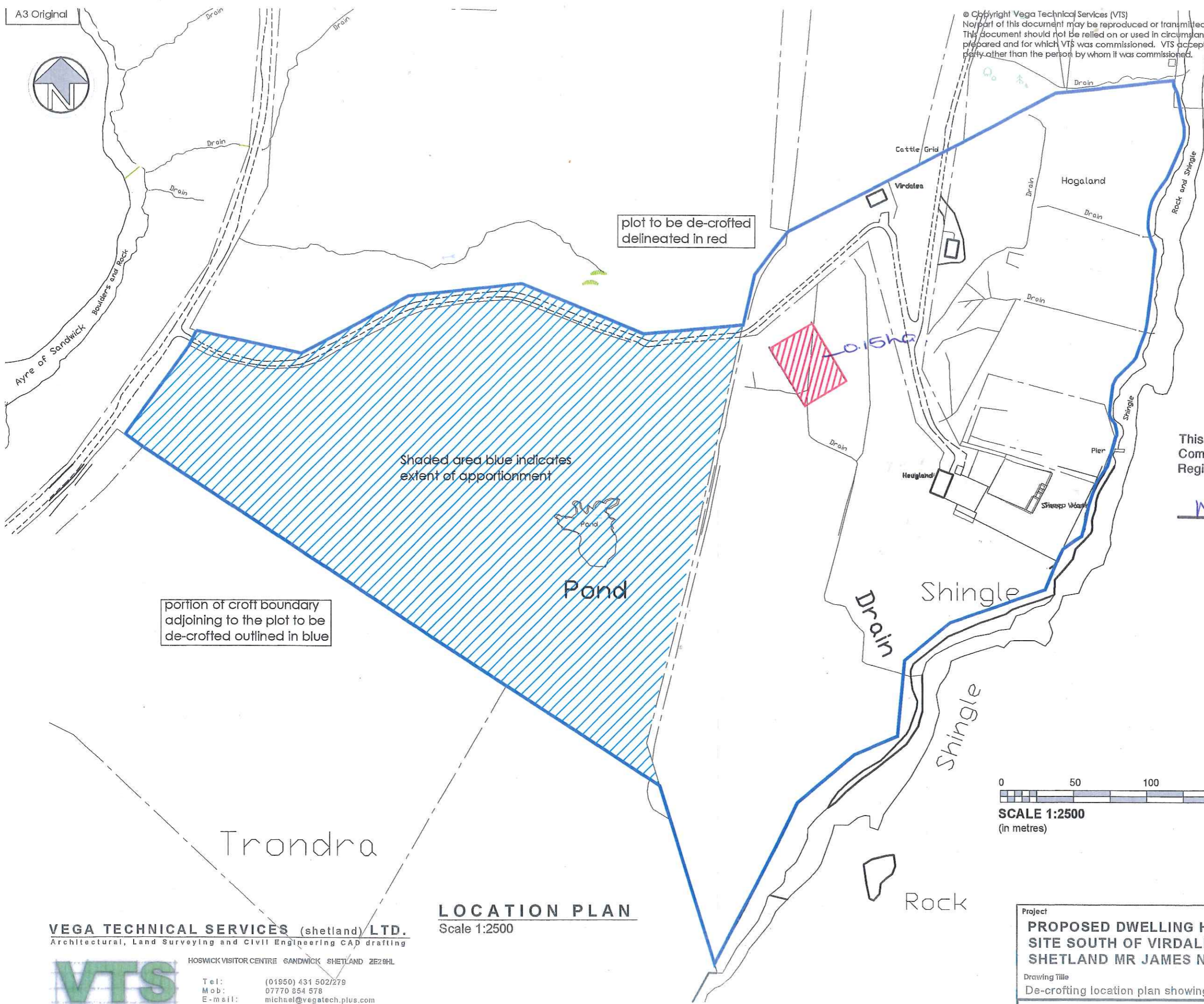

plot to be de-crofted
delineated in red

Shaded area blue indicates
extent of apportionment

portion of croft boundary
adjoining to the plot to be
de-crofted outlined in blue

This is the Plan referred to in the
Commission's Direction issued under
Register No. 23128 Dated 3 November 2015

M. Ross Authorised
Signatory

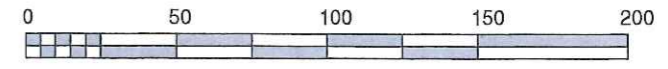

SCALE 1:2500
(in metres)

Trondra

LOCATION PLAN
Scale 1:2500

VEGA TECHNICAL SERVICES (shetland) LTD.
Architectural, Land Surveying and Civil Engineering CAD drafting



HOSWICK VISITOR CENTRE SANDWICK SHETLAND ZE29HL

Tel: (01950) 431 502/279
Mob: 07770 854 578
E-mail: michael@vegatech.plus.com

Project PROPOSED DWELLING HOUSE SITE SOUTH OF VIRDALEA, TRONDRA, SHETLAND MR JAMES NICOLSON		Date Drawn 8.6.15
Drawing Title De-crofting location plan showing croft boundaries		Scale(s) @ A3 1:500
Drawing Status DE-CROFTING	Drawing Number 1034.30	Revision -

A3 Original

VEGA TECHNICAL SERVICES (shetland) LTD.
Architectural, Land Surveying and Civil Engineering CAD drafting



HOSWICK VISITOR CENTRE - SANDWICK - SHETLAND - ZE2 8HL
Tel: (01950) 431 502/279
Mob: 07770 654 978
E-mail: michael@vegatech.plus.com

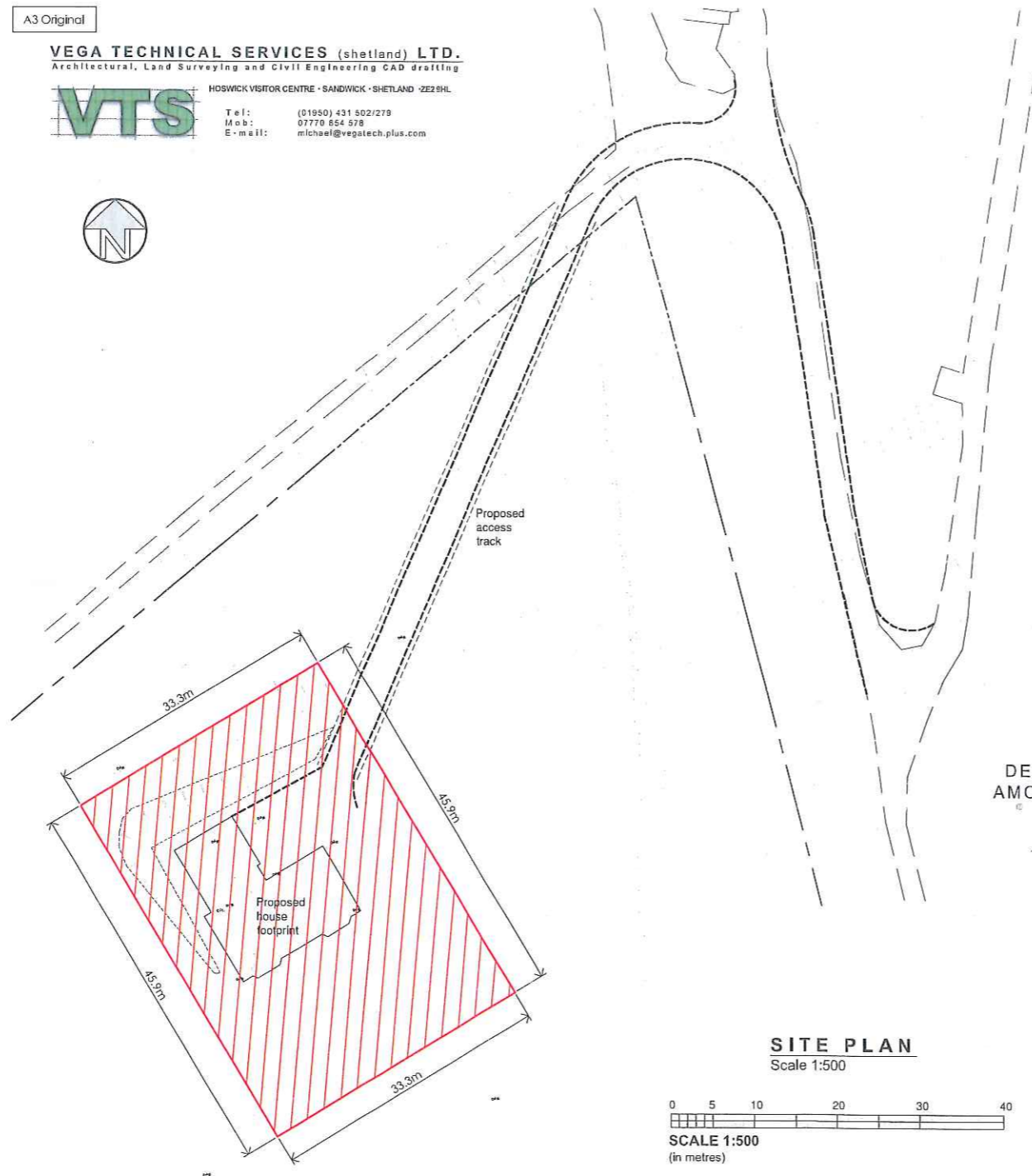

© Copyright Vega Technical Services (VTS)
No part of this document may be reproduced or transmitted in any form without the written permission of VTS.
This document should not be relied on or used in circumstances other than those for which it was originally prepared and for which VTS was commissioned. VTS accepts no responsibility for this document to any other party other than the person by whom it was commissioned.

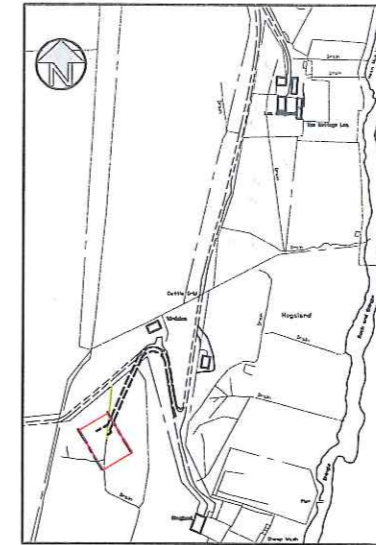

LOCATION PLAN
Scale 1:5000

Part of Ordnance Survey sheet HU 39 35

AREA OF LAND TO BE
DE-CROFTED DELINEATED RED
AMOUNTS TO 1528sq.m (0.15 HA.)
OR THEREBY

SITE PLAN
Scale 1:500

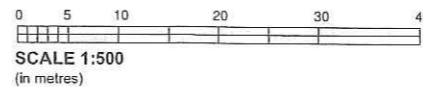

Project		Date Drawn
PROPOSED DWELLING HOUSE SITE SOUTH OF VIRDALEA, TRONDRA, SHETLAND MR JAMES NICOLSON		8.6.15
Drawing Title		Scale(s) @ A3
De-crofting site plan		1:500
Drawing Status	Drawing Number	Revision
DE-CROFTING	1034. 20	-