

CROFTERS (SCOTLAND) ACT 1993
DIRECTION UNDER SECTIONS 24(3) AND 25(1)(a) OF THE 1993 ACT

CROFT: Swenister
REGISTER NUMBER: Z0656
FORMER PARISH: Sandwick
ISLAND AREA: Shetland

We, the CROFTERS COMMISSION, have considered an application by John Mackenzie Flaws for a Direction that part of the above croft, comprising an area of land extending to nine hundred and twelve decimal or ten thousandth parts of a hectare (0.0912 ha) or thereby, as shown delineated in red on the plan attached, should cease to be part of the above croft. We are satisfied that the purpose to which the land is to be put is a reasonable one and that the extent of the land is not excessive in relation to that purpose. We have had regard to the general interest of the crofting community in which the croft is situated, including the demand, if any, for a tenancy of the land if it were now available for letting on the open market, and do now DIRECT that the said area shall cease to be land to which the Crofters Act applies, ON CONDITION THAT the land is (i) as a first change of use, feued, let or used as a site for a proposed dwelling house and (ii) enclosed (so far as not already enclosed) with a stock proof fence or barrier which shall in all time coming be maintained in good order and repair by the owner or their successors within four months of the development being completed.

Given under the Seal of the Commission at Inverness this second day of May, Two thousand and eight.





Authorised Signatory

Note: In terms of section 25(3) of the Act of 1993 breach of the stated condition may entail the making of a further Direction by the Commission that the said land shall again be a vacant croft.



This is the Plan referred to in the
Commission's Direction issued under
Register No. 20656 Dated 02 MAY 2008

[Signature]
Authorised
Signatory

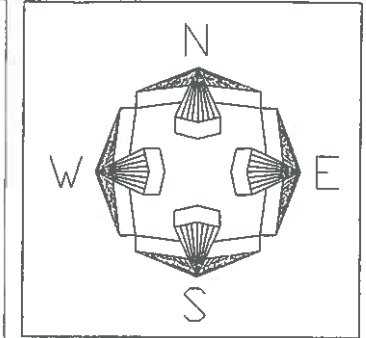
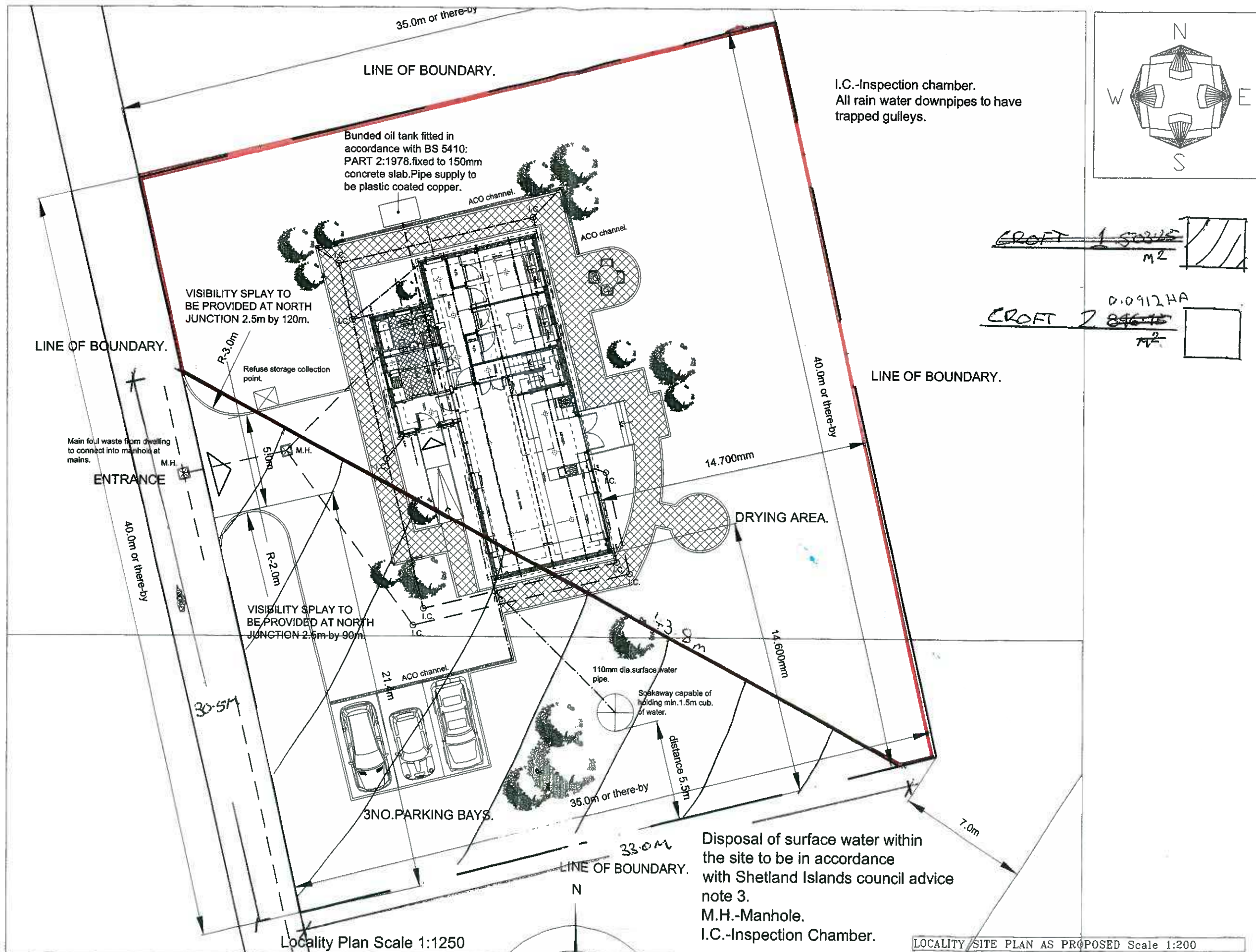

CROFT 1 50346
M²

0.0912 HA
CROFT 2 84645
M²

Proposed Dwelling House at Hoswick, Sandwick, for Mr. T. Williamson.	Rev:	
Site Drainage Layout as proposed.	Rev:	
Date: MAY 2007	Rev: A	Additional land drainage, road moved 25.0m NW.
Scale 1:200	Rev: A	5m boundary amended.
		Drg. no. BRA/L(O)1A.

**Plan Showing Location of
Plots of Land Occupied by
J COGLE, FyORGANHAVEN,
SWINSTER, SANDWICK.**

Scale 1:2500

This is the plan referred to in the
forgoing Disposition

Hubbell

Wm S. Allen

W. B. Bruce

